

Arrival and Dismissal for 2020-2021 School year

- ❖ Prekindergarten and Kindergarten Car Rider Drop Off and Pick up
- ❖ First-Fifth Car Rider Drop Off and Pick-up
- ❖ Bus Drop Off
- ❖ Building Entrance begins 7:15
 - All students will have temperature check and COVID questions answered prior to exiting car. (use QR code below) Staff will verify.
- ❖ Release at 2:05
 - 1st and 2nd will release from West Wing 3rd, 4th and 5th from long hallway
 - Pre-kindergarten, Kindergarten and their siblings will come to the double door and wait to hear name called.

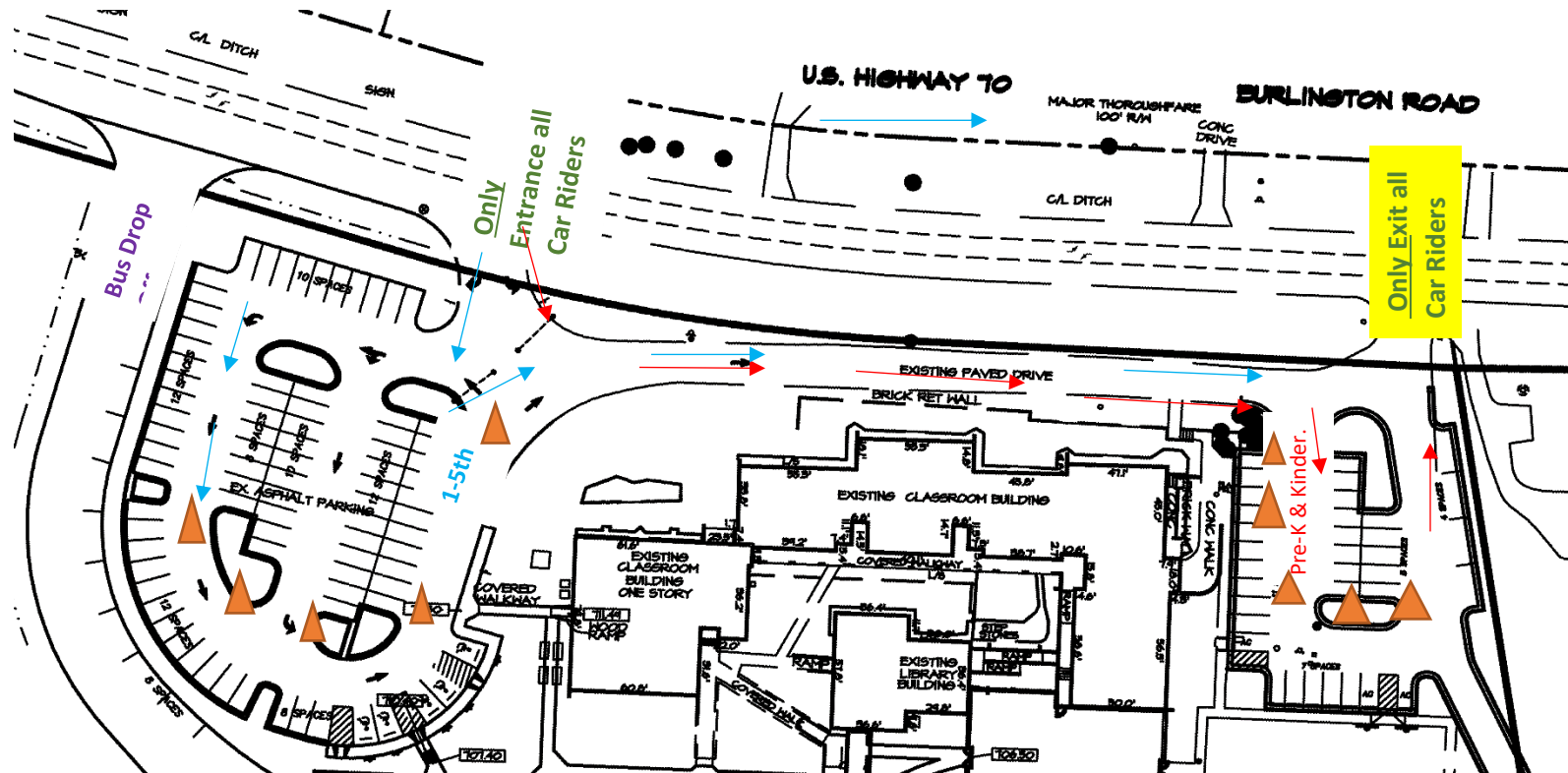

Use QR code to answer COVID questions for your student, while waiting in car rider line.